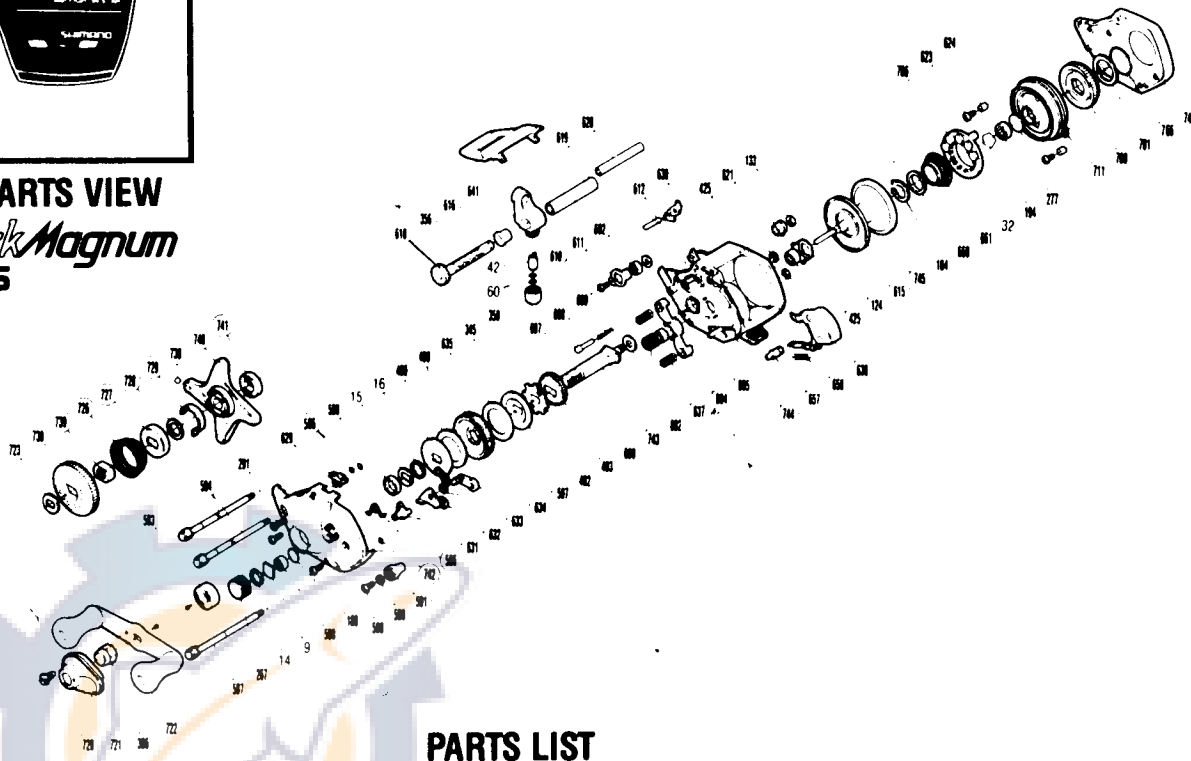

1988 REPAIR MANUALShimano American Corporation, One Shimano Dr.
Irvine, CA 92718**EXPLODED PARTS VIEW****Bantam *Black Magnum*
BKM-201FS****PARTS LIST**

| PART # | DESCRIPTION | PART # | DESCRIPTION | PART # | DESCRIPTION |
|---------------|--------------------------|---------------|----------------------------|---------------|------------------------------------|
| BNT 0009 | Spacer (A) | BNT 0590 | Lock Washer | BNT 0639 | Anti-Reverse Pawl |
| BNT 0014 | Friction Washer (B) | BNT 0591 | Flipping Lever | BNT 0641 | Thumb Rest |
| BNT 0015 | Drag Spring Washer | BNT 0597 | Retractor Spring Guide | BNT 0657 | Clutch Button Guide Pin |
| BNT 0016 | Friction Washer (C) | BNT 0598 | Bushing | BNT 0658 | Flipping Retractor Spring |
| BNT 0032 | Bearing Retainer | BNT 0600 | Idle Gear | BNT 0660 | Spring Spacer |
| BNT 0042 | Line Guide Pawl | BNT 0602 | Drive Shaft Washer "C" | BNT 0661 | Magnet Retainer Spring |
| BNT 0060 | Spacer (Optional) | BNT 0604 | Yoke Spring | BNT 0701 | Thrust Washer Spacer (Optional) |
| BNT 0124 | Spool Shaft Bearing | BNT 0605 | Yoke | BNT 0702 | Dial "O" Ring |
| BNT 0133 | Worm Shaft Retainer | BNT 0607 | Switch Spring Pin | BNT 0706 | Magnet Retainer |
| BNT 0184 | Magnet Retainer Lock | BNT 0608 | Switch Spring | BNT 0708 | Magnet Control Dial |
| BNT 0188 | O Ring | BNT 0609 | Drive Shaft Retainer Screw | BNT 0711 | Dial Case |
| BNT 0194 | Ball Bearing | BNT 0610 | Drive Shaft Retainer | BNT 0720 | Handle Nut Plate Screw |
| BNT 0267 | Cast Control Cap | BNT 0611 | Drive Shaft Bushing | BNT 0721 | Handle Nut Plate |
| BNT 0277 | Spacer (B) | BNT 0612 | Anti-Reverse Pawl Pin | BNT 0722 | Handle Assembly |
| BNT 0291 | Side Plate Screw | BNT 0615 | Bearing Retainer | BNT 0723 | Friction Washer "A" |
| BNT 0306 | Handle Nut | BNT 0616 | Line Guide | BNT 0726 | Pre-Set Spring |
| BNT 0345 | Drive Shaft Washer "B" | BNT 0618 | Worm Shaft | BNT 0727 | Strike |
| BNT 0356 | Worm Bearing "A" | BNT 0619 | Level Wind Guard | BNT 0728 | Pre-Set Washer |
| BNT 0358 | Pawl Cap | BNT 0620 | Stabilizer Bar | BNT 0729 | Strike Spring |
| BNT 0425 | Clutchbutton Lock | BNT 0621 | Worm Bearing "B" | BNT 0730 | Strike Ball |
| BNT 0489 | Key Washer "A" | BNT 0623 | Dial Case Screw | BNT 0738 | Pre-Set Dial |
| BNT 0490 | Drag Washer | BNT 0624 | Screw Support | BNT 0739 | Pre-Set Nut |
| BNT 0492 | Key Washer "B" | BNT 0629 | Anti-Reverse Switch | BNT 0740 | Star Drag |
| BNT 0493 | Anti-Reverse Ratchet | BNT 0631 | Cam Spring | BNT 0741 | Drive Shaft Cam |
| BNT 0583 | Drive Shaft Bearing | BNT 0632 | Flipping Cam | BNT 0742 | Left Side Plate |
| BNT 0584 | Left Side Plate Bolt "C" | BNT 0633 | Joint Plate | BNT 0743 | Drive Shaft |
| BNT 0586 | Bolt Retainer | BNT 0634 | Retractor Spring | BNT 0744 | One-Piece Frame |
| BNT 0587 | Left Side Plate Bolt "A" | BNT 0635 | Drive Gear | BNT 0745 | Spool |
| BNT 0588 | Spool Shaft Bushing | BNT 0637 | Pinion Gear | BNT 0746 | Right Side Plate |
| BNT 0589 | Flipping Lever Screw | BNT 0638 | Clutch Button | | |

Prices and specifications subject to change without notice.

OCTOBER, 1987